

HOSEBED CAPACITIES
 ① 1200' OF 4.00" L.D.H
 ② 200' OF 3.00" D.J. HOSE

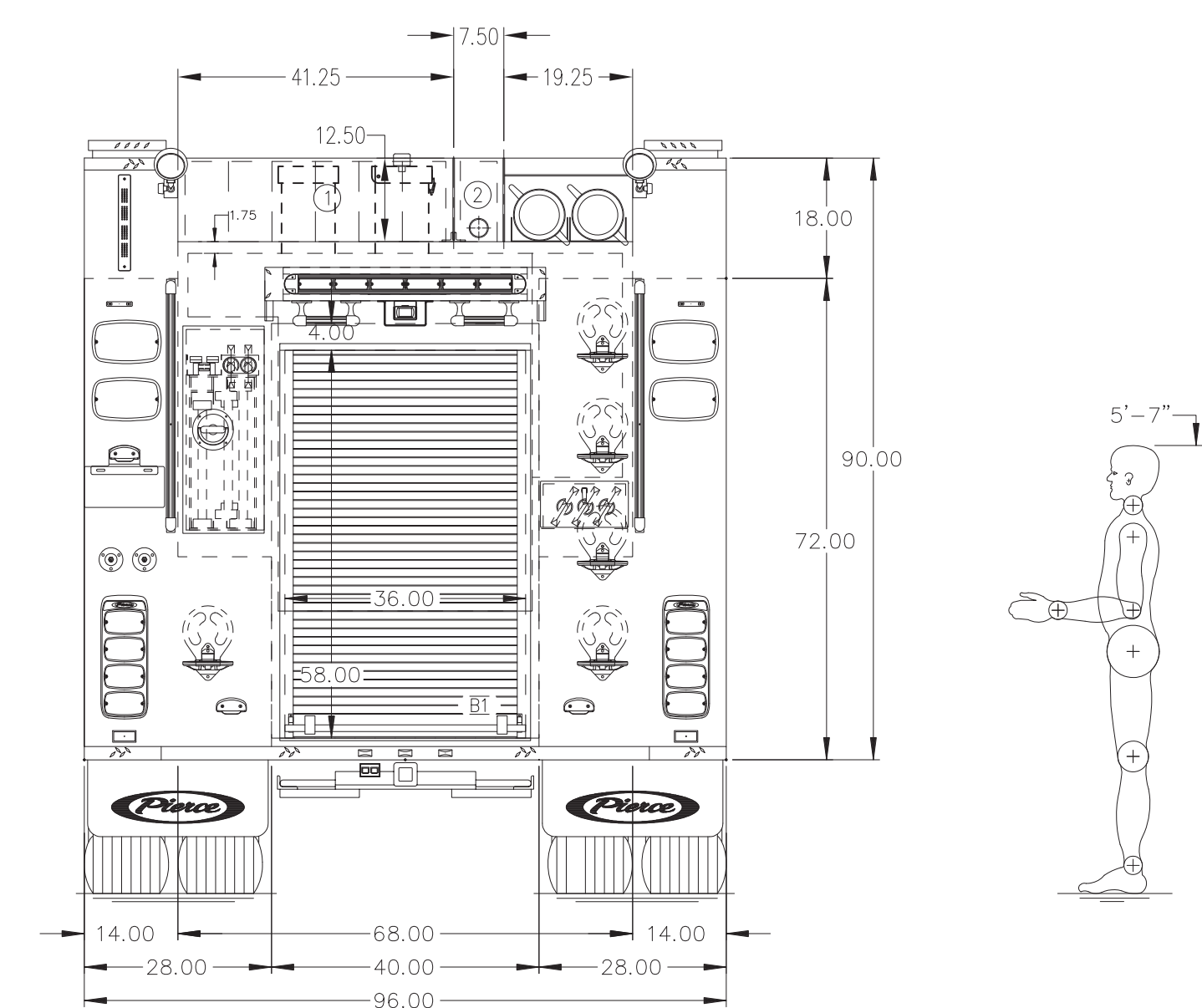
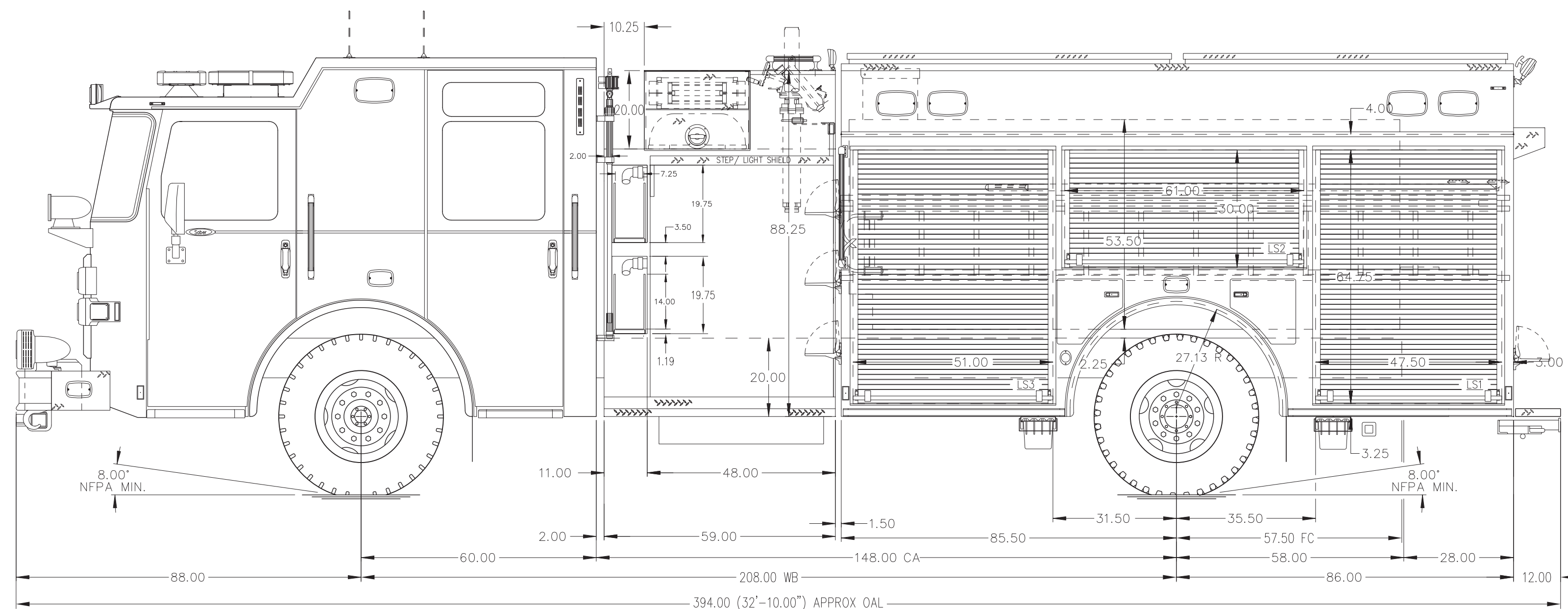

ALUMINUM BODY

MAXIMUM O.A.L. 384.00"

MAXIMUM O.A.H. 115.00"

NOTE
 DIMENSIONS SHOWN ARE APPROXIMATE AND ARE SUBJECT TO MINOR DEVIATIONS AS MAY OCCUR OR BE NECESSARY IN CONSTRUCTION. MINOR DETAILS NOT SHOWN.

REV	DATE	BY	CH	SABER FR
08JUN23		KRG	-	

PIERCE MANUFACTURING INC.	PROPOSAL	761
	SCALE	DATE
	DRAWN BY	13JAN2023
	CHECKED BY	N/A
TITLE	1500-D-1275P, 1250 WATER W/ 25 FOAM, 171" BODY, FDLR (1) CROSSLAY, (2) SPEEDLAYS, LADDERS BTWN TANK & SS	
FOR	SPRINGFIELD VOLUNTEER FIRE DEPARTMENT EAST SPRINGFIELD, PA	
DWG NO.	PRELIMINARY PRINT ONLY	
	SHEET SIZE	SHEET NO.
	D	1 OF 1