

- HOSEBED CAPACITIES
- ① 400' OF 1.75" D.J. POLY HOSE
 - ② 300' OF 3.00" D.J. POLY HOSE
 - ③ 1500' OF 5.00" D.J. POLY HOSE

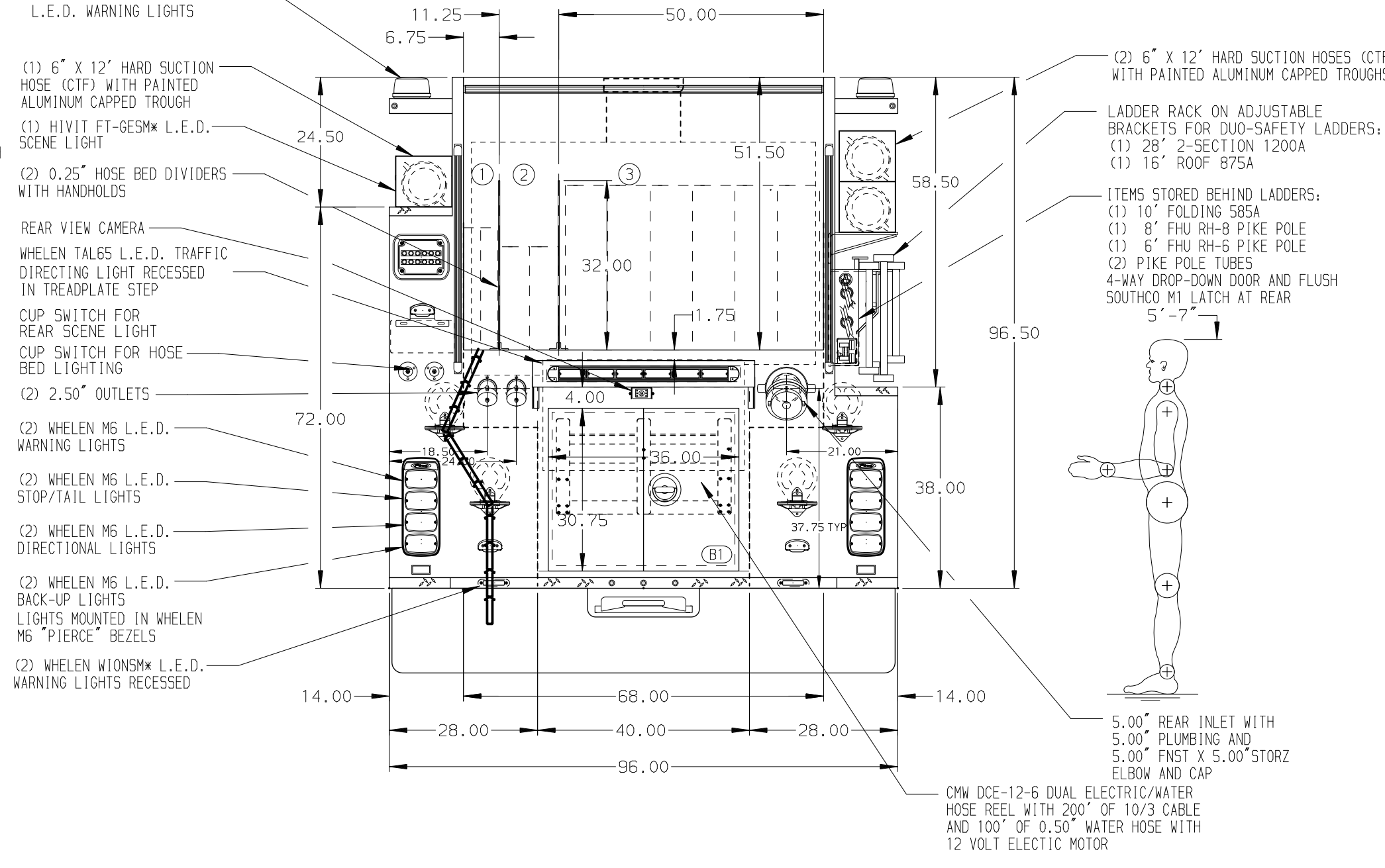
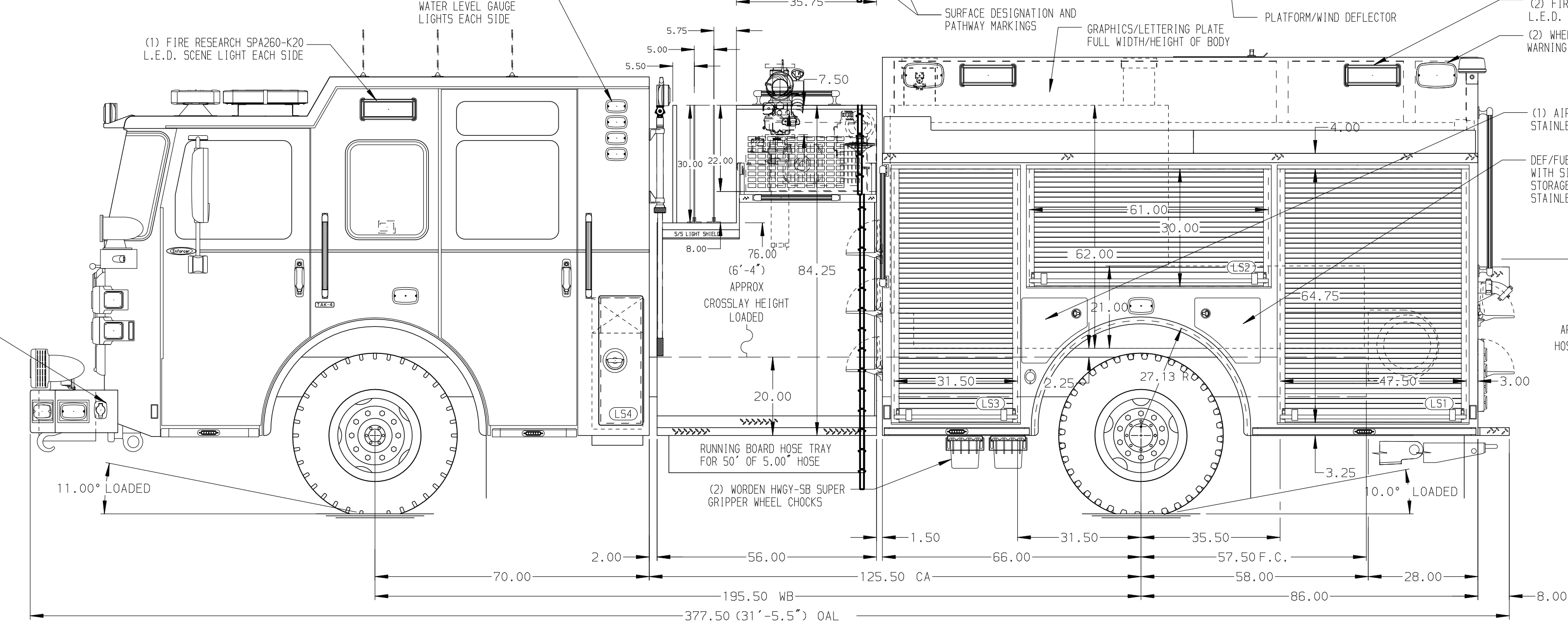

STAINLESS STEEL BODY MAXIMUM O.A.L. 377.50" MAXIMUM O.A.H. 126.00" SIDE ROLL AND FRONTAL IMPACT PROTECTION

NOTE
DIMENSIONS SHOWN ARE APPROXIMATE AND ARE SUBJECT TO MINOR DEVIATIONS AS MAY OCCUR OR BE NECESSARY IN CONSTRUCTION. MINOR DETAILS NOT SHOWN.

1. ONSPOT AUTOMATIC TIRE CHAINS TO BE PROVIDED AT REAR
2. BATTERY CHARGER LOCATED BEHIND DRIVER'S SEAT
3. BATTERY CHARGER INDICATOR BEHIND DRIVER'S SEAT DISPLAYED THROUGH WINDOW
4. AIR INLET WITH DISCONNECT COUPLING LOCATED PER ORDER
5. CIRCUIT BREAKER PANEL LOCATED PER ORDER
6. SIX 120V DUPLEX RECEPTACLES LOCATED PER ORDER
7. PARTITION BETWEEN L51/B1 AND R51/B1

REV	DATE	BY	CH	ENFORCER
30JUN23	LME	PHA		MAKE
12APR23	LME	PHA		PIERCE
09JAN23	LME	PHA		MODEL

		JOB NO.	37973
		SCALE	DATE
TITLE	2000-D-1050P, 1000 WATER W/ 50 FOAM, 152" BODY (3) CROSSLAYS, DELUGE, GENERATOR, LADDER BRACKETS		
FOR	GLEN MOORE FIRE COMPANY NO. 1 GLEN MOORE, PENNSYLVANIA		
DWG NO.	37973AD		
CHECKED BY	PHA	DRAWN BY	LME
SHEET SIZE	D	CHECKED BY	PHA
SHEET NO.	1 OF 1	DWG NO.	37973AD